

1600# STANDPIPE LINEAR
6' to 9' - VARIABLE REACH

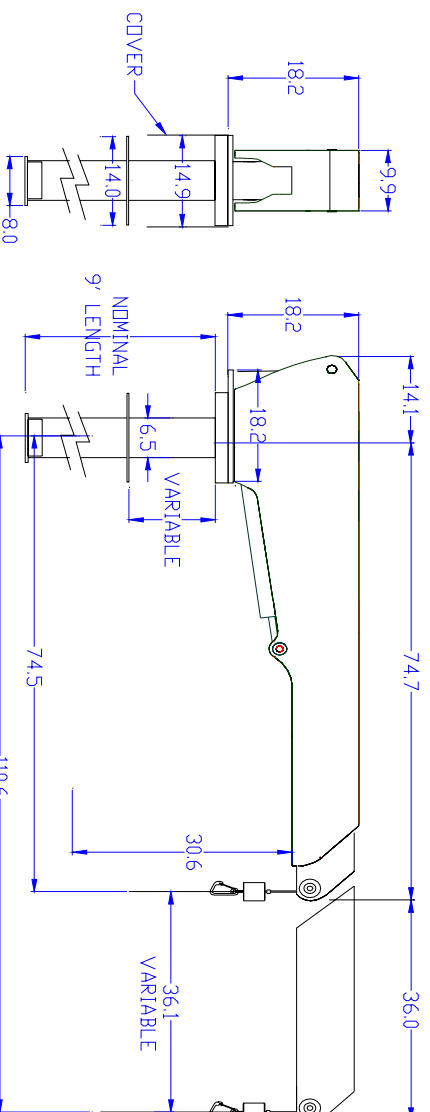
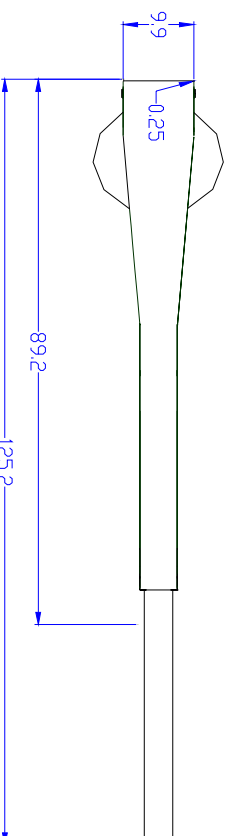
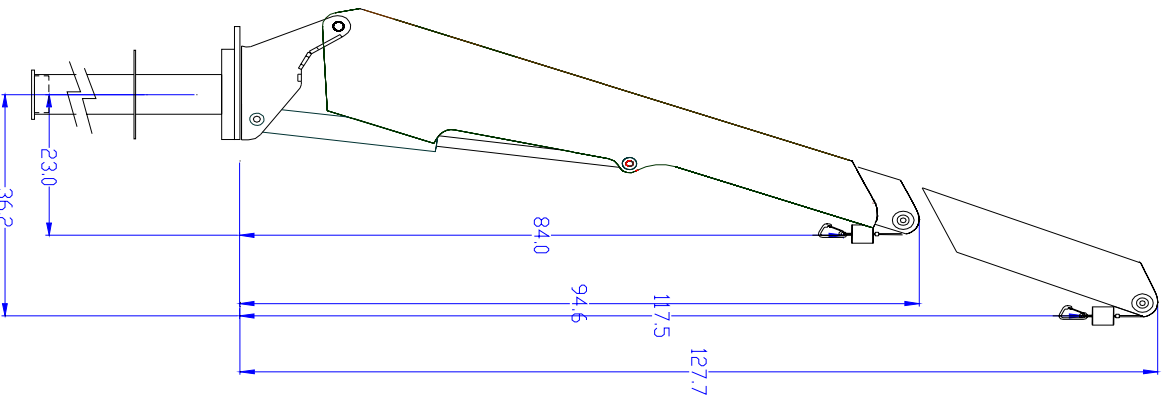

Technicals - 1600# Lifting capacity.

- * 4 Functions ALL hydraulic. SILENT operation. LUFF - EXTEND - HOIST - ROTATE.
- * Remote pendant operated. 9' lead.
- * 12v, 24, or 115v Hydraulic pump and hydraulic lines included.
- * VARIABLE REACH. Minimum reach 6'2" - anywhere in between - 9' maximum extended.
- * Samsonite composite rope for hoisting. Stronger than stainless steel cable.
- * Full 360 degrees continuous rotation.
- * All aluminum 5086 construction. Stainless steel polished extendable nose.
- * Painted to match w/ 3 part Linear Poly Urethane coating.
- (finishing process of Acid etch, Alodine, 2 part epoxy, 3 part poly urethane paint.)

SCALE		DATE	
Equipment No.	NICK JACKSON CO.	Rev.	
EQUIP_NO.?		Date	
WO_NO.?	1600#-L.P	01-04-05	
		Drawing No.	DWG